

TOTAL EXTENT (LEAST EXTENT AS PER DOCUMENT) : 3642 SQ.M ✓
 ROAD AREA : 1048 SQ.M ✓
 NO.OF.PLOTS : 26 Nos. ✓



NOTE:

1. SPLAY - 1.5M X 1.5M
2. MEASUREMENTS ARE INDICATED EXCLUDING SPLAY DIMENSION
3.  ROAD AREA WAS HANDED OVER TO THE LOCAL BODY
 VIDE GIFT DEED DOCUMENT NO. 2218/2019, DATED:11.03.2019, @ SRO REDHILLS.

CONDITION:

(I) DR RULE NO: 29 (11)
 THE COST OF LAYING IMPROVEMENTS TO THE SYSTEMS IN RESPECT OF ROAD, WATER SUPPLY, SEWERAGE, DRAINAGE OR ELECTRIC POWER SUPPLY THAT MAY BE REQUIRED AS ASSESSED BY THE COMPETENT AUTHORITY, SHALL BE BORNE BY THE APPLICANT. ✓

LEGEND :

-  SITE BOUNDARY ✓
-  ROADS GIFTED TO LOCAL BODY ✓
-  EXISTING ROAD ✓

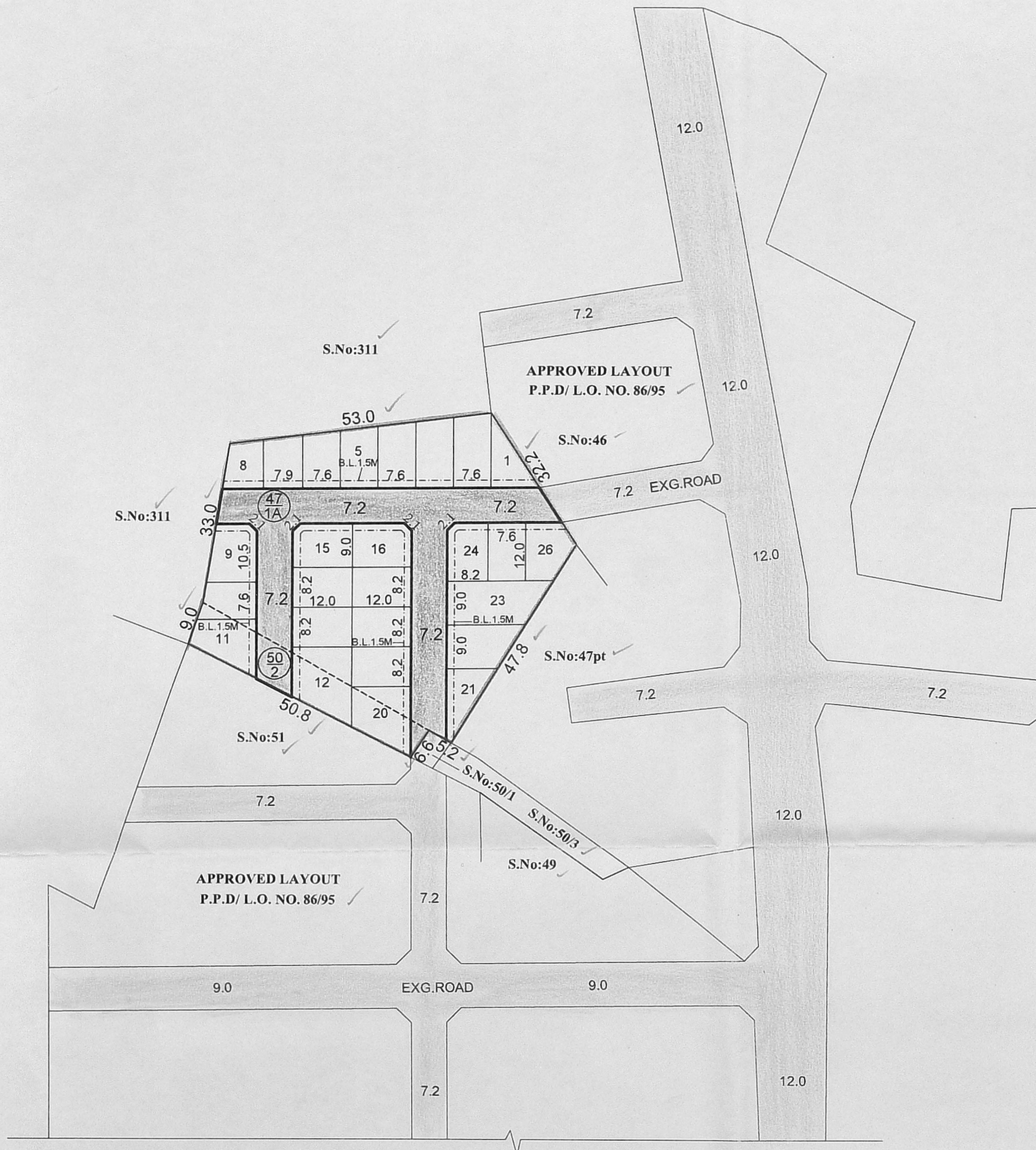

CONDITION:-
 THE LAYOUT APPROVAL IS VALID SUBJECT TO OBTAINING SANCTION FROM THE LOCAL BODY CONCERNED

P.P.D	NO	34
L.O		2019
APPROVED		
VIDE LETTER NO : L1/428/2019 ✓		
DATED : / 03 / 2019		

Hg
22/3/19

FOR SENIOR PLANNER (MSB)
 CHENNAI METROPOLITAN
 DEVELOPMENT AUTHORITY 4/5

B. Anon
21/3/19
PREPARED BY

A.P.
21/3/19
P.A.II

A.P.
21/3/2019

SHOLAVARAM PANCHAYAT UNION

LAYOUT OF HOUSE SITES IN S.Nos: 47/1A AND S.No.50/2 OF ALAMATHI VILLAGE.

SCALE - 1:800 (ALL MEASUREMENTS ARE IN METRE)

